

# Native Pollinator Advisory Garden Registry Board Minutes

President  
Jessica Fong

Vice President  
Laura Milker

Secretary  
Lorraine Kells

Board Member  
Naomi Davis

Board Member  
Brittany Buckles

Ex-Officio Board  
Members

Breanne Heath

Ron Daye

Gloria Pittman  
Deputy  
Commissioner –  
DSS

Alderman  
Hopkins  
2<sup>nd</sup> Ward  
Alderman

## Meeting February 6, 2025

Minutes submitted by Lorraine Kells, Secretary

### 1. Call to Order

- Meeting was called to order By Jessica Fong at 2:30 pm.

### 2. Roll Call

- In attendance: Jessica Fong, Laura Milkert, Lorraine Kells, Ron Daye, Gloria Pittman, and Breanne Heath
- Not in Attendance: Brittany Buckles, Alderman Hopkins
- Attending: Gabriela Wagener-Sobrero, Environmental Justice Manager, City of Chicago; May Toy, President, Skinner Park, Loomis Garden; Daniella Periera, Openlands; Chris Kessler, Openlands; Alma Olavarría Gallegos, Openlands; Liz Kozik, Chicago Botanic Garden; Emily Conn, Lincoln Park Zoo; Emily Parkinson, Greater Rockwell Org.; Claudia Galeno Sanchez Women for Green Spaces, Naomi Davis, Blacks in Green, Board member attending as general public.

### 3. Public Comments:

- May Toy raised a concern that time and location of the meeting and agenda were not posted on the City's website; a violation of the Open Meetings Act. She stated that it is important for transparency and would render any actions taken by the board illegal. As a registry, not a certification, rules should follow the ordinance so that garden practices do not harm pollinators. May asked the board to prioritize creation of the registry before addressing the issue of parkway gardens which require liability insurance and a CDOT parkway permit.
- Liz Kozik spoke of low growing native plant species and creating resources for public spaces. The Botanic Garden wants to be a resource. Liz mentioned 52 perennial species from 12'-24' in height, but a few like little bluestem can reach a mature height  $\geq 5'$ .
- Alma Olavarría Gallegos presented a slide deck (see below) with the deep dive that UFAB had done with their working looking into the City's landscape ordinance and neighboring or related ordinances to engage and encourage public participation. The UFAB will compare municipal codes across many municipalities. Los Angeles and Evanston have stated height maturity of  $\leq 36''$  Three questions were posed to this board for a vote at another meeting: **1** Would the Advisory Board approve recommendations to increase height maximum? **2** Is the proposed increase of 24'' agreeable to the Board? **3** Would the Board support continued

collaboration with UFAB for the passage of such an ordinance.

Board members continued discussion of plant material height, plant species types and the possibility of a positive response from local nurseries to supply material. Flowering weeds, certain types of clover, new pollinator habitat and habitat corridors that provide food sources and nesting space for pollinators should be considered. Breanne recommended the state list of noxious weeds.

#### Action Items

Develop a time line for the registry draft

Set approval date by DSS

Open the Registry

Meeting Adjourned 4:30pm

# Deep Dive: Parkways and the 10 Inch Rule

For the Native Pollinator  
Registry Advisory Board

February, 2005



# Agenda

- ◆ **Definitions and Issue Setting**
- ◆ **Ordinance Location and Language**
- ◆ **Comparing Across Municipalities**
- ◆ **Overview of Work to Date**
- ◆ **Questions**

# Parkway Definition

Parkway means that portion of the public way between a public street and the nearest parallel property line including sidewalk areas





Current rules:  
Board cannot  
approve plants  
(except trees)  
over 10 inches  
in parkways



Must maintain clear  
sightlines to ensuring  
public safety

# Ordinance Location

## Chicago Laws

### Municipal Code of Chicago

Streets, Public Ways, Parks, Airport and Harbors

### Title 10

Trees, Plants and Shrubs

### Chapter 10-32

Managed native and pollinator garden registry

### Ordinance 10-32-055

Proposed Language Change

Section 10-32-055 (d) (2)

#### ✓ Municipal Code of Chicago

##### ▶ MUNICIPAL CODE OF CHICAGO

##### ▶ TITLE 1 GENERAL PROVISIONS

##### ▶ TITLE 2 CITY GOVERNMENT AND ADMINISTRATION

##### ▶ TITLE 3 REVENUE AND FINANCE

##### ▶ TITLE 4 BUSINESSES, OCCUPATIONS AND CONSUMER PROTECTION

##### ▶ TITLE 5 HOUSING AND ECONOMIC DEVELOPMENT

##### ▶ TITLE 6 HUMAN RIGHTS\*

##### ▶ TITLE 9 VEHICLES, TRAFFIC AND RAIL TRANSPORTATION

##### ▼ TITLE 10 STREETS, PUBLIC WAYS, PARKS, AIRPORTS AND HARBORS

##### ▶ CHAPTER 10-4 ARRANGEMENT OF CITY STREETS

##### ▶ CHAPTER 10-8 USE OF PUBLIC WAYS AND PLACES

##### ▶ CHAPTER 10-12 STREET IMPROVEMENTS

##### ▶ CHAPTER 10-14 COMPLETE STREETS

##### CHAPTER 10-30

##### ▶ TELECOMMUNICATIONS EQUIPMENT ON, OVER OR UNDER PUBLIC WAYS

##### ▼ CHAPTER 10-32 TREES, PLANTS AND SHRUBS

10-32-010 Definitions.

10-32-020 Authority of commissioner.

10-32-030 Authority of deputy commissioner.

10-32-040 Trees, shrubs or other plant

##### AND SHRUBS

10-32-010 Definitions.

10-32-020 Authority of commissioner.

10-32-030 Authority of deputy commissioner.

10-32-040 Trees, shrubs or other plant materials - Public nuisance.

10-32-050 Care of parkway.

10-32-055 Managed native and pollinator garden registry.





...Failure to maintain the managed native and pollinator garden in accordance with this section and the rules hereunder may result in the Commissioner removing the garden from the registry.

(d) To be eligible to be in the registry:

- (1) the managed native and pollinator garden shall be on an occupied property or a community garden that meets the definition and requirements of Section [17-9-0103.5](#).
- (2) the managed native and pollinator garden shall not have any plants encroach on the public sidewalk or extend beyond the property line. Similarly, if a permit for a managed native and pollinator garden in the parkway is acquired, any managed native and pollinator garden in a parkway shall not have plants, excluding trees, **taller than ten inches**.

Emphasis added





# Comparing Across Cities

Promoting Green Stormwater Infrastructure Safely

## Los Angeles

Plant materials at full maturity must be lower than 36" in height from the top of the curb or roadway.

## Evanston

Parkway planting cannot exceed 36 inches.

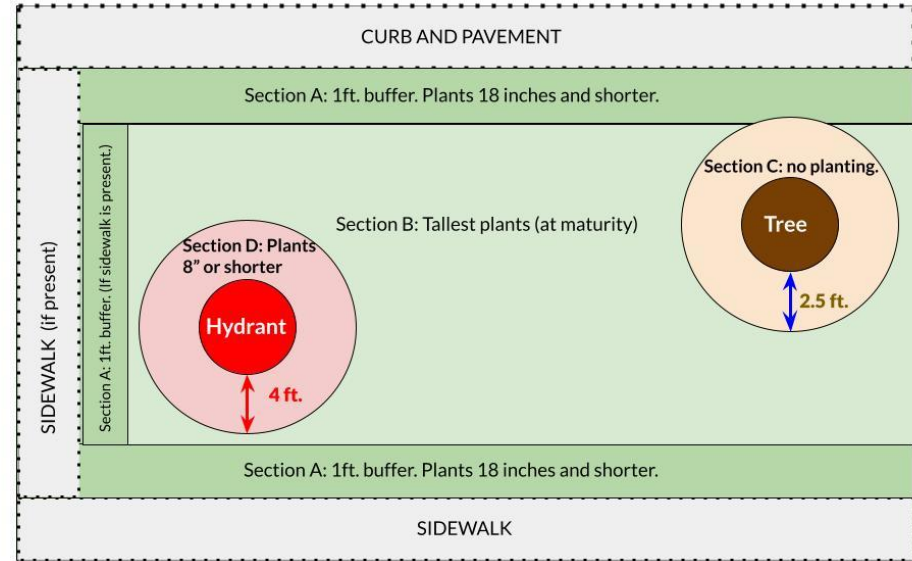

- Any pavement: sidewalk, street, etc.
- Parkway / planting area
- Section C: within 2.5ft of any City -owned tree
- Section D: within 4ft. of any fire hydrant

Evanston Planting Sections

# Planting In Chicago Parkways

Overview of Policy Working Group Work

# Urban Forestry Advisory Board

**Review City Plans and Policies**

**Compare Municipal Policies**

**Propose Policy and Ordinance Updates**

**Policy Working Group**

**Work Across City Departments**

**Encourage Public Participation**

**Outreach to Stakeholders**

**Ordinance Level Changes Identified**



**Parkway Planting Height Limit**



# UFAB Policy WG has..

- Identified Code for Ordinance Change
- Discussed changes with relevant City Departments
- Identified relevant stakeholders
- Engaged relevant stakeholders

Photo by Jorge Garcia/Openlands



# Questions:

Would this Advisory Board approve a recommendation to increase the height maximum for parkway plant heights?

Is the proposed increase of 24 inches agreeable to the Board?

Would the Board support continued collaboration with UFAB for the passage of such an ordinance?